

Vegetation will be deemed removed due to the proposed development and the removal of vegetation will be done in accordance with the current guidelines.

Assessments will be undertaken during the construction phase to ensure that retained trees shown for retention, no guarantees that they will survive.

Tree Numbers were derived from a professional report (28 of 2024) in accordance with the current guidelines.

This plan is proposed for removal.

Proposed boundaries are shown from boundary to boundary and can only be constructed to one street. Clause 54 of the Bass Coast Council Planning Scheme 2015.



Lot 16, 48-56 Cuthbert Street, Corinella

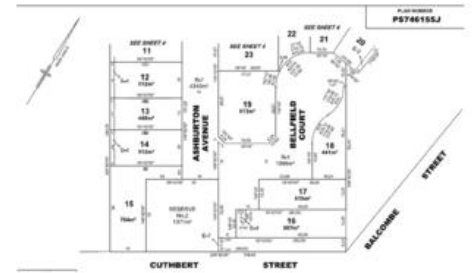

BAYSIDE CORINELLA REAL ESTATE

Secure Your Future Address Today and Pay in 2 years!!

An idyllic waterside locale. Looking for that easy care lifestyle??

This location could be for you!!

Corinella is known for its 24 hour boat ramp, great fishing, scenic coastal walks and magnificent sunsets.

To be a part of this developing community invest now!!

Local Primary School and Kindergarten 5 minutes' drive.

Local shopping precinct of Grantville 10 minutes away.

Phillip Island and major shopping centre approximately 20 minutes away.

Easy commute on the dual lane Bass Highway to the CBD and Wonthaggi.

You may also view this property on www.yourlandshop.com.au

Disclaimer - We have obtained all information in this document from sources we believe to be reliable. However, we cannot guarantee its accuracy. Prospective purchasers are advised to carry out their own investigations. www.1stre.com.au

Price \$255,000
Property Type residential
Property ID 2200
Land Area 607 m²

Agent Details

Faye Bennett - 0409 803 605

Office Details

Your Land Shop - SR
 03 5678 5408

Your
Land Shop
 Residential - Country - Seaside

The above information provided has been furnished to us by the vendor/s. We have not verified whether or not that information is accurate and do not have any belief in one way or the other in its accuracy. We do not accept any responsibility to any person for its accuracy and do no more than pass it on. All interested parties should make and rely upon their own inquiries in order to determine whether or not this information is in fact accurate.